



6107 S. COULTER STE. 300
AMARILLO, TEXAS 79119
PH: 806-922-5532

FOR SALE

DALLAM COUNTY 480

\$2200/acre or \$1,056,000

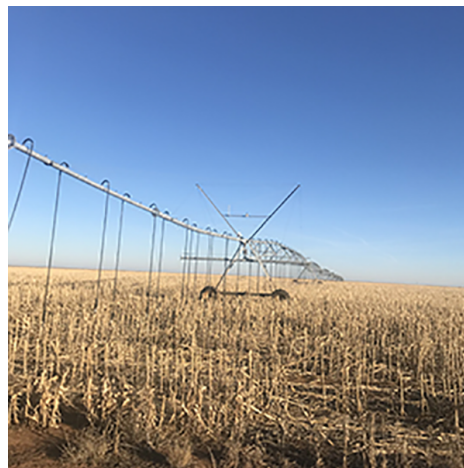

PROPERTY DESCRIPTION

AREA: SE Dallam Co

LOCATION: 9 miles west of State Highway 287 on FM 297 on North side of road.
½ mile west of Dallam/Sherman County Line.

ACRES: 480

IRRIGATION WELLS: 2, one well drilled in 1998 produces approximately 550 gpm , 2nd well produces approximately 200 gpm.

PIVOTS: 4 Zimmatic ¼ mile pivots

PRICE: \$2200/acre or \$1,056,000

NORTH PLAINS WATER DISTRICT LOG

NORTH PLAINS WATER DISTRICT WELL # DA-2459

NAME V J LAND & CATTLE (JOE REINART)

SURVEY DAY L & C CO BLK 1T SEC 6

CLASS C TEST PUMP 762 GPM

STAGES 7 BOWL SIZE 12 COLUMN SIZE 8

**NORTH PLAINS GROUND WATER
CONSERVATION DISTRICT No. TWO**
Application for Water Well Permit

X-fer From TP 0251

Co. Well No. DA-2459
Dist. Well No. _____
Time: 8:00
Date Application _____
Filed Out: 12-31-97
Classification Maximum
of Well: C Yield: 800

JOE REINART

HCR 4 BOX 44 STRATFORD, TX 79084-9604

Name of Landowner or Well Owner: IRRIGATION
Mailing Address of Landowner or Well Owner: _____
1. Proposed Use: _____
2. Approximate date drilling will start: ASAP
3. Driller: DBE
4. County: DALLAM
5. Location of well: Miles North or South _____ and Miles East ~~XXXX~~ EAST from the town of: DALHART
6. Legal Description: SE 1/4 of Section 6 Block _____ Survey DAY L&C CO
League or Other Description: _____
7. Location on Property: 790 measured yards from the SOUTH section line, and 670 measured yards from the 888 EAST section line. GPS: Latitude _____ Longitude _____
(East or West) (North or South)

PERMIT IS VALID FOR 120 DAYS IF APPROVED.

MARK DOT INSIDE CIRCLE ● within Red Square for proposed well location. (Red square indicates 1 Quarter Section)
(Each small square equals 220 Yards by 220 Yards.)

MARK X, Showing 3 closest wells, and/or applications.

Please Make Sure Your Measurements are Correct. They Will be Checked for Accuracy. Well Must Be Drilled Within 10 Yards of Location Specified, District Rule 12.

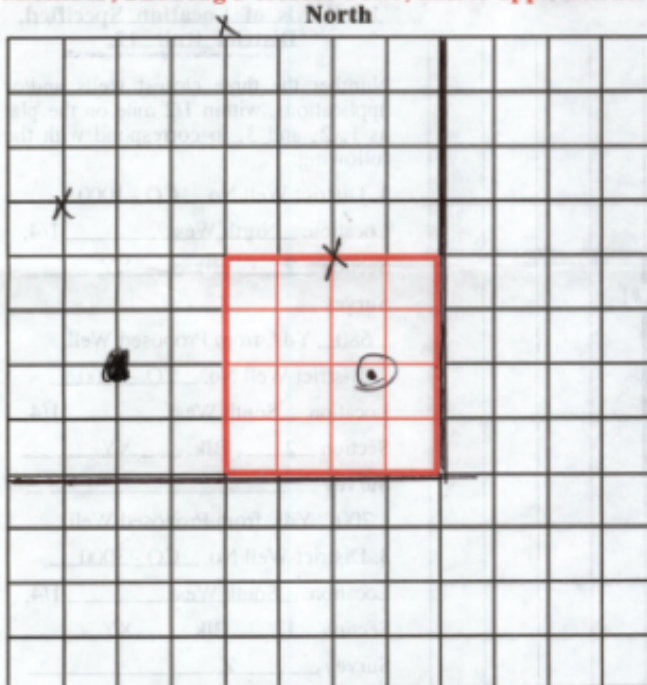

(Example on Back)

Number the three closest wells and/or applications, within 1/2 mile on the plat as 1, 2, and 3, to correspond with the following:

1. District Well No. _____
Location: _____ 1/4,
Section _____, Blk. _____
Survey _____
_____ Yds. from Proposed Well.
2. District Well No. _____
Location: _____ 1/4,
Section _____, Blk. _____
Survey _____
_____ Yds. from Proposed Well.
3. District Well No. _____
Location: _____ 1/4,
Section _____, Blk. _____
Survey _____
_____ Yds. from Proposed Well.

COMMENTS: no other wells within 1/2 mile

I do hereby certify that I have read the foregoing statement, and that each and all of the items therein contained are true to the best of my knowledge and belief. I agree that I must furnish the District, as required by law, the completed Registration and Log of Well form within thirty (30) days after completion of this well. I also agree that I must furnish the District, as required by law, the completed Pump and Well Completion form before producing water from this well.

*Refunded 3/10/98 CH# 1442
TP-0251*

This notice given by: DALHART BUTANE & EQUIPMENT CO INC P.O. BOX 1031 DALHART, TX 79022
SIGNATURE (OWNER OR AGENT) TITLE ADDRESS

Approved subject to spacing rules from existing wells or prior permits.

1. Robert Reinart County Committeeman 2. Robert Reinart County Committeeman 3. Charles Taylor County Committeeman

White Original: District Office file,
Canary: Duplicate District file, Pink: County Committee file, Gold: Applicant

DA-2459

State of Texas
WELL REPORTTDLR, WWD
P.O. BOX 12157
AUSTIN, TX 78711

1) OWNER <u>V.J. LAND & CATTLE</u> ADDRESS <u>HCR 4 BOX 44</u> <u>STRATFORD</u> <u>TX</u> <u>79004-9504</u> (Name) (Street or RFD) (City) (State) (Zip)	
2) ADDRESS OF WELL: County <u>DALLAM</u> <u>18 MILES EAST OF DALHART</u> GRID # <u>02-63-5</u> (Street or RFD) (City) (State) (Zip)	
3) TYPE OF WORK (Check): <input checked="" type="checkbox"/> New Well <input type="checkbox"/> Deepening <input type="checkbox"/> Reconditioning <input type="checkbox"/> Plugging	4) PROPOSED USE (Check): <input type="checkbox"/> Monitor <input type="checkbox"/> Environmental Soil Boring <input type="checkbox"/> Domestic <input type="checkbox"/> Industrial <input checked="" type="checkbox"/> Irrigation <input type="checkbox"/> Injection <input type="checkbox"/> Public Supply <input type="checkbox"/> De-watering <input type="checkbox"/> Testwell If Public Supply well, were plans submitted to the TNRCC? <input type="checkbox"/> Yes <input type="checkbox"/> No
5) <div style="text-align: right;">X</div>	
6) WELL LOG: Date Drilling: _____ Started <u>1-28</u> <u>19 98</u> Completed <u>1-28</u> <u>19 98</u>	7) DRILLING METHOD (Check): <input type="checkbox"/> Driven <input type="checkbox"/> Air Rotary <input checked="" type="checkbox"/> Mud Rotary <input type="checkbox"/> Bored <input type="checkbox"/> Air Hammer <input type="checkbox"/> Cable Tool <input type="checkbox"/> Jetted <input type="checkbox"/> Other _____
8) Borehole Completion (Check): <input type="checkbox"/> Open Hole <input type="checkbox"/> Straight Wall <input type="checkbox"/> Underreamed <input checked="" type="checkbox"/> Gravel Packed <input type="checkbox"/> Other _____ If Gravel Packed give interval ... from <u>10</u> ft. to <u>506</u> ft.	
9) CEMENTING DATA [Rule 338.44(1)] Cemented from <u>0</u> ft. to <u>10</u> ft. No. of sacks used <u>16</u> _____ ft. to _____ ft. No. of sacks used _____ Method used <u>PUMP</u> Cemented by <u>MARQUEZ</u> Distance to septic system field lines <u>N/A</u> ft. Method of verification of above distance <u>N/A</u>	
10) SURFACE COMPLETION <input type="checkbox"/> Specified Surface Slab Installed [Rule 338.44(2)(A)] <input type="checkbox"/> Specified Steel Sleeve Installed [Rule 338.44(3)(A)] <input type="checkbox"/> Pileless Adapter Used [Rule 338.44(3)(b)] <input checked="" type="checkbox"/> Approved Alternative Procedure Used [Rule 338.71]	
11) WATER LEVEL Static Level <u>331</u> ft. below land surface Date <u>2-10-98</u> Artesian flow _____ gpm Date _____	
12) PACKERS: Type _____ Depth _____ NONE	
13) TYPE PUMP: <input checked="" type="checkbox"/> Turbine <input type="checkbox"/> Jet <input type="checkbox"/> Submersible <input type="checkbox"/> Cylinder <input type="checkbox"/> Other _____ Depth to pump bowls, cylinder, jet, etc., <u>480</u> ft.	
14) WELL TESTS: Type Test: <input checked="" type="checkbox"/> Pump <input type="checkbox"/> Bailor <input type="checkbox"/> Jetted <input type="checkbox"/> Estimated Yield: <u>762</u> gpm with <u>NOT TAKEN</u> ft. drawdown after <u>N/A</u> hrs.	
15) WATER QUALITY: Did you knowingly penetrate any strata which contained undesirable constituents? <input type="checkbox"/> Yes <input checked="" type="checkbox"/> No If yes, submit "REPORT OF UNDESIRABLE WATER" Type of water? _____ Depth of strata _____ Was a chemical analysis made? <input type="checkbox"/> Yes <input checked="" type="checkbox"/> No	
I hereby certify that this well was drilled by me (or under my supervision) and that each and all of the statements herein are true to the best of my knowledge and belief. I understand that failure to complete items 1 thru 15 will result in the log(s) being returned for completion and resubmittal.	
COMPANY NAME <u>DALHART BUTANE & EQUIPMENT CO., INC.</u> WELL DRILLER'S LICENSE NO. <u>53186</u> (Type or print)	
ADDRESS <u>P.O. BOX 1031</u> <u>DALHART</u> <u>TEXAS</u> <u>79022</u> (Street or RFD) (City) (State) (Zip)	
(Signed) <u>JASON MARQUEZ</u> (Licensed Well Driller)	(Signed) <u>AARON CASTILLO</u> (Registered Driller Trainee)
Please attach electric log, chemical analysis, and other pertinent information, if available.	