

**FOR SALE**  
**DUMAS CC ESTATES**

**\$54,000 - \$56,000**

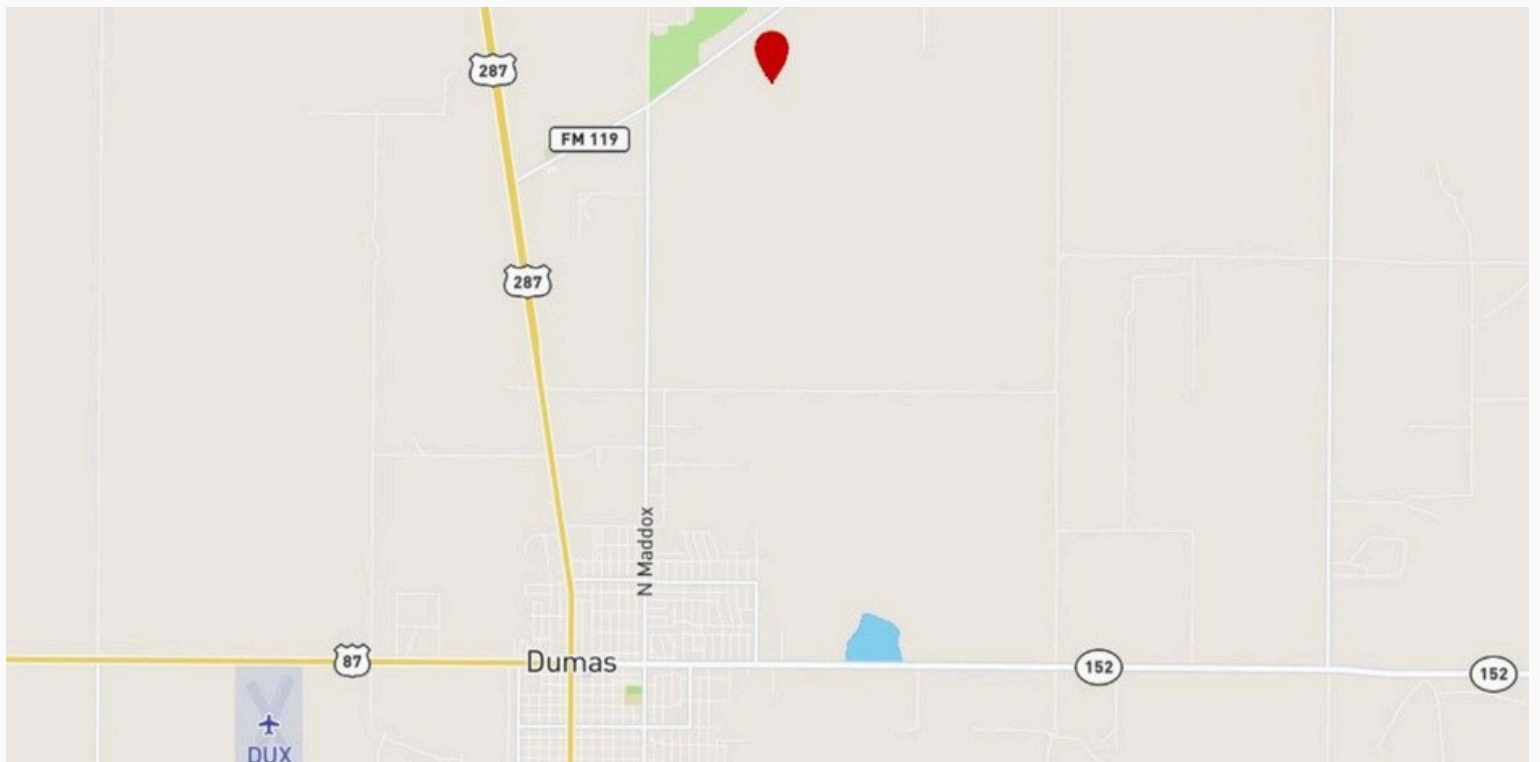



**\$56,000 - Yellow Lots**  
**\$54,000 - Blue Lots**

**DUMAS CC ESTATES**

**\$54,000 - \$56,000**

## PROPERTY OVERVIEW

### Dumas Country Club Estates

**PROPERTY:** 1/2 Acre Lots

**LOCATION:** 3 miles north of Dumas, TX and 1/2 mile east on FM 119. Property is on the south side of the road. South of the Pheasant Trails Golf Course.

**LOT PRICE:** \$54,000 or \$56,000/Lot

**ROAD TYPE:** Caliche roads to access lots to be provided by seller.

**WATER:** All lots will be provided with water from a public water system permitted by the Texas Commission on Environmental Quality.

**RESTRICTIONS:** There are restrictions on the property.

Restrictions will be provided to buyer. New double wide trailers are allowed. Used trailer houses and new single wide trailers are restricted.

#### **OWNER FINANCING**

Owner financing is available with the following terms:

- Down Payment - 20%
- Term - 10 Years
- Interest rate - 14%

**BUYER EXPENSES:** Buyer will pay for septic, survey, and for some lots electric line.